

ITEM	PART NAME	MATERIAL	QTY.
1	DISC	HIGH DENSITY POLYETHYLENE	1
2	CAP NUT	303 SST	1
3	CLIP RING	CHROME PLATED SPRING WIRE	1
4	CHAIN	316L SST	1
5	LATCH RING	CHROME PLATED STEEL	1

NOTES:

1. SINGLE POLY BAGGED, EACH BAG LABELLED WITH GFP LOGO, PART NUMBER, AND "CLEANED FOR OXYGEN SERVICE".

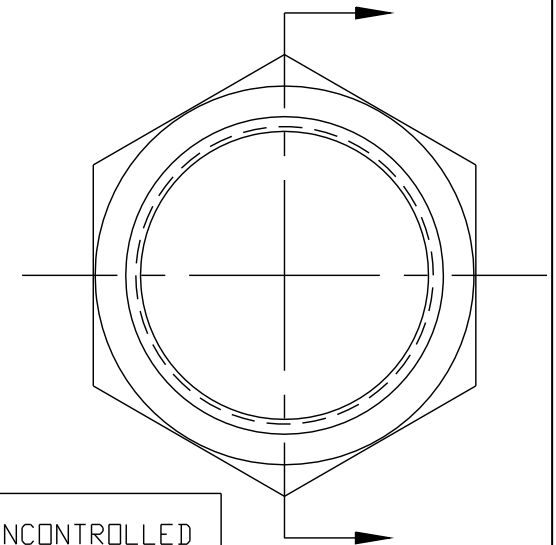
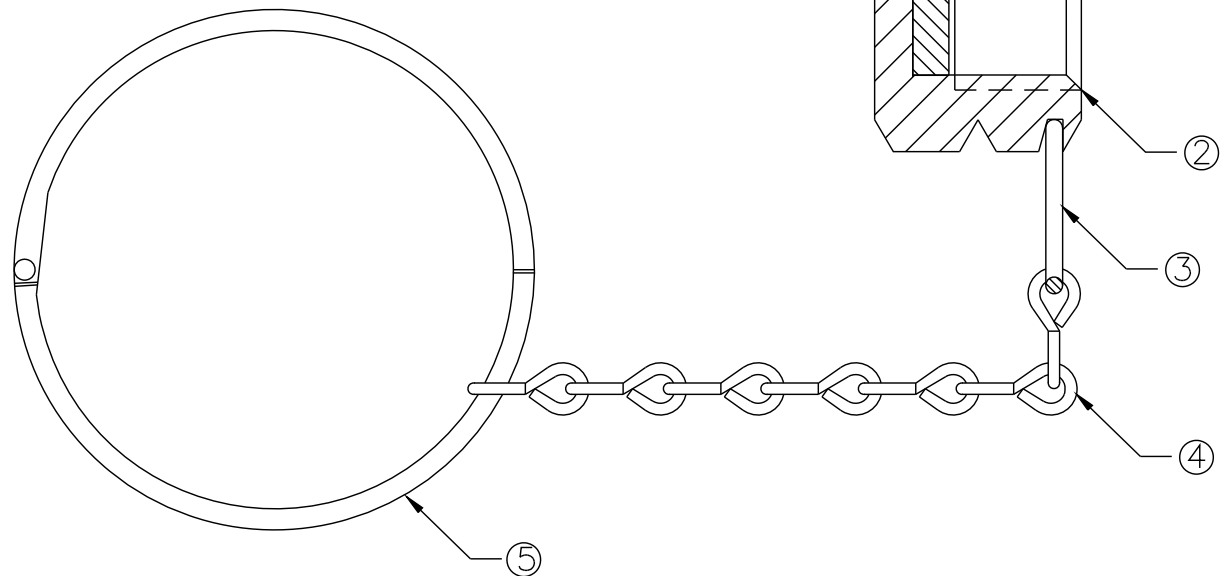

UNCONTROLLED
FOR REFERENCE
ONLY
MB 3/15/2005

GasFlo Products Inc.
Fairfield, N.J.

SALES DRAWING- VALVE OUTLET CAP W/ POLY DISC
SST CGA 330 & 350

THIS DOCUMENT CONTAINS INFORMATION THAT IS THE PROPRIETARY AND CONFIDENTIAL PROPERTY OF GASFLO PRODUCTS INC. AND MAY BE USED ONLY FOR AUTHORIZED PURPOSES. THIS DOCUMENT MAY NOT BE REPRODUCED WITHOUT GASFLO PRODUCTS INC. PRIOR WRITTEN CONSENT.

DWN MB	SCALE: NTS
APPVD	DATE 3/15/05

DWG SALES-CAP-33SS-PR