

CYLINDER VALVE OUTLET
RIGHT HAND
MALE

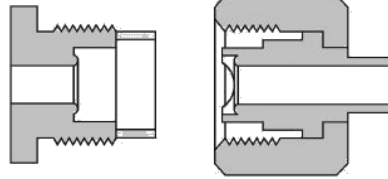

INLET CONNECTION
RIGHT HAND
FEMALE NUT & NIPPLE

CONNECTION NO. 720

All dimensions are in inches - for reference only, subject to change.

CYLINDER VALVE OUTLET CAPS

PART NUMBER	DESCRIPTION	L
CAP-GT71SS	STAINLESS STEEL GAS TIGHT L/ GASKET	1.27"
CAP-GT71SS-K	STAINLESS STEEL GAS TIGHT W/ PCTFE GASKET	1.27"
CAP-GT71SS-NI	STAINLESS STEEL GAS TIGHT W/ NICKEL 200 GASKET	1.27"

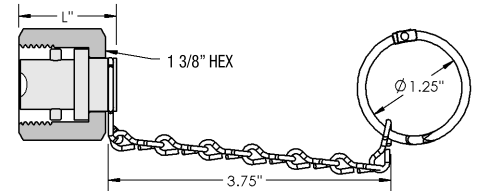

GASKETS

PART NUMBER	DESCRIPTION	D	H	W
GSK-DISS-K	VIRGIN PCTFE	.562	.210	.125
GSK-DISS-NI	NICKEL 200	.562	.210	.125
GSK-DISS-AL	ALUMINUM 2024	.562	.210	.125

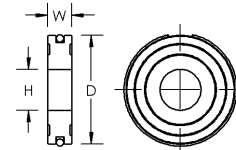

INLETS X 1/4\"

PART NUMBER	DESCRIPTION	L
INL-720SS-4M	STAINLESS STEEL 9 Ra EP	3.00"
INL-720SS-4M-N	STAINLESS STEEL 9 Ra EP W/ NICKEL GASKET	3.00"

EP = Electropolished ID

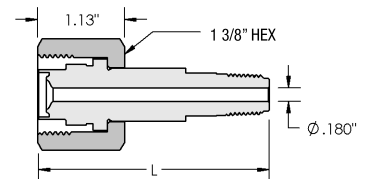

INLETS X 1/4\"

PART NUMBER	DESCRIPTION	L
INL-720SS-4MFS	STAINLESS STEEL 9 Ra EP	3.00"
INL-720SS-4MFS-N	STAINLESS STEEL 9 Ra EP W/ NICKEL GASKET	3.00"

EP = Electropolished ID

SCM = Semiconductor Material (VIM/VAR)

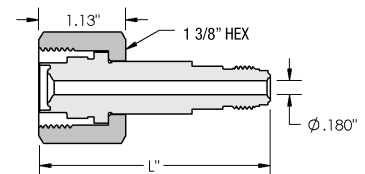

INLETS X ORBITAL TUBE WELD STUB (INCLUDES SILVER PLATED 303 SS NUT & 316L SCM SS NIPPLE)

PART NUMBER	DESCRIPTION	L	T
INL-720SS-4TS	STAINLESS STEEL 9 Ra EP	2.50"	1/4\"OD X .035\" WALL
INL-720SS-4TS-N	STAINLESS STEEL 9 Ra EP W/ NICKEL GASKET	2.50"	1/4\"OD X .035\" WALL
INL-720SS-6TS	STAINLESS STEEL 9 Ra EP	2.375"	3/8\"OD X .035\" WALL
INL-720SS-6TS-N	STAINLESS STEEL 9 Ra EP W/ NICKEL GASKET	2.375"	3/8\"OD X .035\" WALL
INL-720SS-8TS	STAINLESS STEEL 9 Ra EP	2.375"	1/2\"OD X .049\" WALL
INL-720SS-8TS-N	STAINLESS STEEL 9 Ra EP W/ NICKEL GASKET	2.375"	1/2\"OD X .049\" WALL

EP = Electropolished ID

SCM = Semiconductor Material (VIM/VAR)

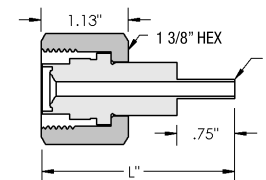

ACCESSORIES

PART NUMBER	TORQUE SETTING
TW-DISS-NI	35 FT-LB FOR NICKEL & ALUMINUM GASKETS
TW-DISS-K	12 FT-LB FOR PCTFE GASKETS

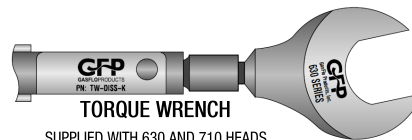

SUPPLIED WITH 630 AND 710 HEADS

INLET OPTIONS

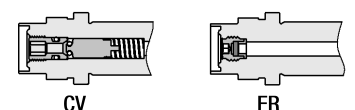

W/ INTEGRAL CHECK VALVE W/ FLOW RESTRICTOR ORIFICE

COMPLETE PIGTAIL CONNECTION X ORBITAL TUBE WELD STUB

(INCLUDES SILVER PLATED 303 SS NUT, 316L SCM SS NIPPLE, 303 SS BLANK PLUG & GASKET)

PART NUMBER	DESCRIPTION	L	T
PT-720SS-4TS	STAINLESS STEEL 9 Ra EP W/ PCTFE GASKET	2.50"	1/4" OD x .035" WALL
PT-720SS-6TS	STAINLESS STEEL 9 Ra EP W/ PCTFE GASKET	2.375"	3/8" OD x .035" WALL
PT-720SS-8TS	STAINLESS STEEL 9 Ra EP W/ PCTFE GASKET	2.375"	1/2" OD x .049" WALL
PT-720SS-4TS-N	STAINLESS STEEL 9 Ra EP W/ NICKEL GASKET	2.50"	1/4" OD x .035" WALL
PT-720SS-6TS-N	STAINLESS STEEL 9 Ra EP W/ NICKEL GASKET	2.375"	3/8" OD x .035" WALL
PT-720SS-8TS-N	STAINLESS STEEL 9 Ra EP W/ NICKEL GASKET	2.375"	1/2" OD x .049" WALL

EP = Electropolished ID

SCM = Semiconductor Material (VIM/VAR)

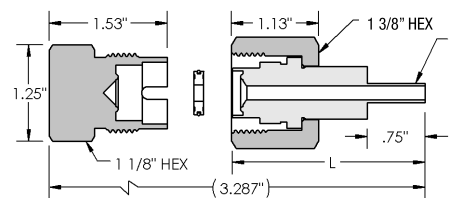

COMPLETE PIGTAIL ADVANCED PERFORMANCE CONNECTION X ORBITAL TUBE WELD STUB

(INCLUDES SILVER PLATED 303 SS AP NUT, 316L SCM SS NIPPLE, 303 SS BLANK PLUG & GASKET)

PART NUMBER	DESCRIPTION	L	T
PT-AP-720SS-4TS-N	STAINLESS STEEL 9 Ra EP W/ NICKEL GASKET	2.50"	1/4" OD x .035" WALL
PT-AP-720SS-8TS-N	STAINLESS STEEL 9 Ra EP W/ NICKEL GASKET	2.375"	1/2" OD x .049" WALL

EP = Electropolished ID

SCM = Semiconductor Material (VIM/VAR)

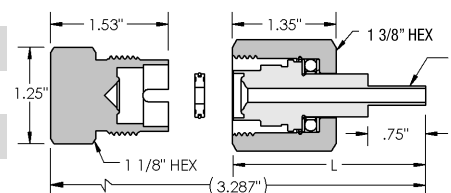

COMPLETE PIGTAIL CONNECTION X 1/4 MALE FACE SEAL

(INCLUDES SILVER PLATED 303 SS NUT, 316L SCM SS NIPPLE, 303 SS BLANK PLUG, & GASKET)

PART NUMBER	DESCRIPTION	L
PT-720SS-4MFS	STAINLESS STEEL 9 Ra EP W/ PCTFE GASKET	3.00"
PT-720SS-4MFS-N	STAINLESS STEEL 9 Ra EP W/ NICKEL GASKET	3.00"

EP = Electropolished ID

SCM = Semiconductor Material (VIM/VAR)

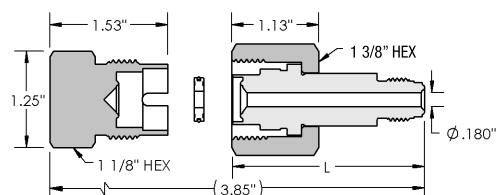

VALVE OUTLET ADAPTORS

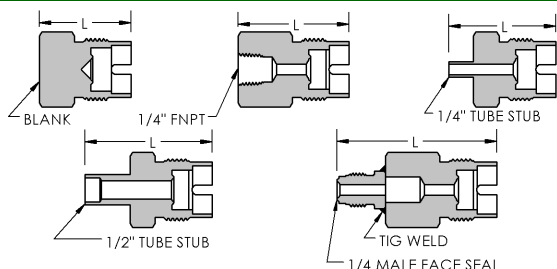

PART NUMBER	DESCRIPTION	L
AD-72SS-BL	316L SS BLANK PLUG*	1.53"
AD-720MSS-4FNPT	316L SS 1/4" FNPT	1.85"
AD-720MSS-4MFS	316L SS 1/4 MALE FACE SEAL	2.67"
AD-720MSS-4TS	316L SS 1/4" TUBE STUB	1.78"
AD-720MSS-8TS	316L SS 1/2" TUBE STUB	2.12"

*Blank plug available with ring & chain on request

3 PIECE ADAPTORS (INCLUDES SILVER PLATED 303 SS NUT, 316L SS NIPPLE & SS OUTLET ADAPTOR)

PART NUMBER	DESCRIPTION	L
AD-720F705M-SS	STAINLESS STEEL CGA 720 FEMALE X CGA 705 MALE	4.15"
AD-720F660M-SS	STAINLESS STEEL CGA 720 FEMALE X CGA 660 MALE	3.90"
AD-720FDIN6M-SS	STAINLESS STEEL CGA 720 FEMALE X DIN 6 MALE	3.77"
AD-720FAFNORCM-SS	STAINLESS STEEL CGA 720 FEMALE X AFNOR C MALE	3.86"
AD-720FJIS22RM-SS	STAINLESS STEEL CGA 720 FEMALE X JIS 22R MALE	3.96"

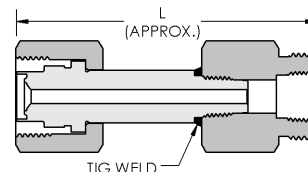

Additional configurations available on request

VALVE, FITTING OR OTHER COMPONENT FUNCTION, PROPER INSTALLATION, MATERIALS COMPATIBILITY, ADEQUATE RATINGS, OPERATION AND MAINTENANCE ARE THE RESPONSIBILITY OF THE SYSTEM DESIGNER AND USER.



PRODUCT FAILURE, IMPROPER SELECTION OR IMPROPER USE OF THE PRODUCTS AND/OR SYSTEMS DESCRIBED HEREIN OR RELATED ITEMS CAN CAUSE DEATH, PERSONAL INJURY AND PROPERTY DAMAGE.



MADE IN USA
CGA720-2016 Rev. A

GasFlo Products Inc. CGA Ultra High Integrity Service Cylinder Connections are Manufactured to CGA V-1 Standards
Additional materials and configurations available on request. Minimum order quantities may be required.

19 Industrial Road, Fairfield, NJ 07004 Phone: 973-276-9011 Fax: 973-276-9014 www.gasflo.com

Member Compressed Gas Association