



GasFlo Products HPST-8 Series Valves are air operated to allow for remote automated cycling. This high pressure, forged body, spring type diaphragm design is available in normally closed or normally open configurations. Valve remains in a static state unless proper actuation pressure is continuously applied. HPST-8 Series Valves provide superior leak integrity in 3/8" and 1/2" applications with pressure ranges from vacuum to 3500 psig.

FEATURES

- FORGED BODY CONSTRUCTION
- AIR OPERATED ACTUATION
- NORMALLY CLOSED OR NORMALLY OPEN
- SPRING TYPE DESIGN
- METAL DIAPHRAGM SEALED
- MEDIUM FLOW, HIGH PRESSURE
- POSITIVE SHUT-OFF
- ULTRASONICALLY DI CLEANED
- 100% HELIUM LEAK TESTED
- AVAILABLE WITH ELECTROPOLISHED ID SURFACE ON REQUEST
- CUSTOM MATERIALS AND CONFIGURATIONS AVAILABLE ON REQUEST

MATERIALS OF CONSTRUCTION

- **BODY OPTIONS:**
316L STAINLESS STEEL
- **SEAT OPTIONS:**
PCTFE OR POLYIMIDE
- **WETTED DIAPHRAGM:**
ELGILOY®
- **SPRING ASSEMBLY:**
316L STAINLESS STEEL
- **LOWER STEM:**
316L STAINLESS STEEL
- **BONNET NUT:**
303 STAINLESS STEEL
- **UPPER STEM:**
416 STAINLESS STEEL
- **ACTUATOR HOUSING:**
NICKEL PLATED ALUMINUM

ELGILOY® REGISTERED TRADEMARK OF ELGILOY SPECIALTY METALS.

APPLICATIONS

- BULK SYSTEMS
- TUBE TRAILERS
- MASTER SHUT-OFF VALVE
- MANIFOLD SYSTEMS
- GAS/FLUID CONTROL PANELS

END CONNECTION OPTIONS

- 1/2" MALE AND 1/2" FEMALE PIPE THREAD
- 3/8" AND 1/2" TUBE SOCKET WELD
- 1/2" PIPE SOCKET WELD
- 1/2 MALE AND 1/2 FEMALE FACE SEAL
- 3/8" AND 1/2" ORBITAL TUBE WELD
- CUSTOM CONNECTIONS



DIMENSIONAL INFORMATION

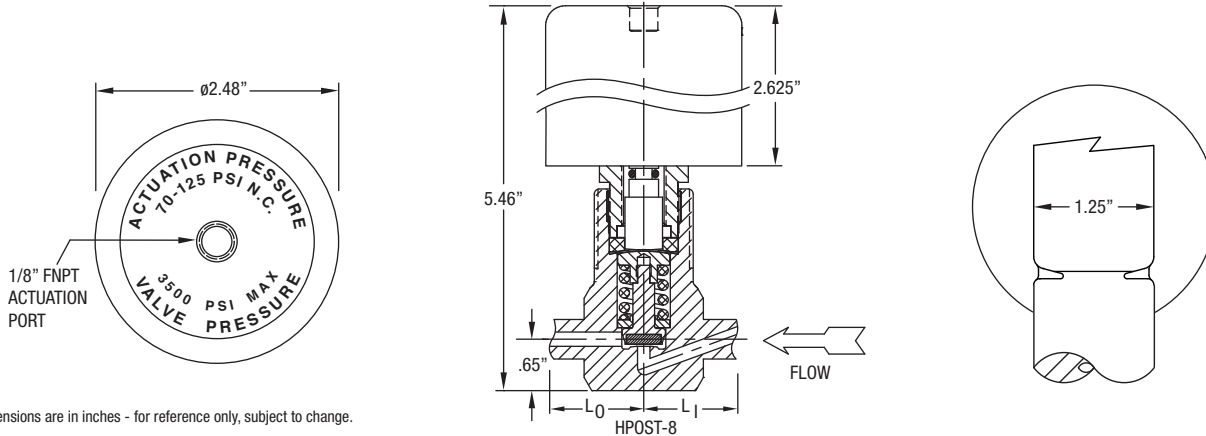

SPECIFICATIONS

PRESSURE RATING: 3500 PSIG	STANDARD SEAT MATERIAL: PCTFE	MAX. ALLOWABLE SEAT LEAKAGE: 2 x 10 ⁻⁸ ATM CC/SEC He
ACTUATION PRESSURE: 70 - 125 PSIG	TEMPERATURE LIMITS PCTFE SEAT: -65° F TO 150° F	MAX. INBOARD LEAKAGE: 2 x 10 ⁻⁸ ATM CC/SEC He
FLOW COEFFICIENT Cv = .30	TEMPERATURE LIMITS OPTIONAL POLYIMIDE SEAT: -65° F TO 250° F	ACTUATION PORT: 1/8" FEMALE NPT
SEAT ORIFICE SIZE: $\varnothing.156"$	WETTED DIAPHRAGM: ELGILOY®	

ORDERING INFORMATION

TYPICAL PART NUMBER

PRODUCT FAMILY VALVES	VLV	-	HPST	-	8	8	-	SS	-	TS	TS	-	PI	OPTIONAL FEATURES PI = POLYIMIDE SEAT 3 = 2 X 1.87" TUBE EXTENSIONS* 5 = 2 X 4" TUBE EXTENSIONS* <small>*AVAILABLE WITH ORBITAL TUBE WELD ENDS ONLY</small>
SERIES HPST (NORMALLY CLOSED) HPOST (NORMALLY OPEN)														OUTLET CONNECTION F = FEMALE NPT ($L_0 = 1.595"$) M = MALE NPT ($L_0 = 1.50"$) MFS = MALE FACE SEAL ($L_0 = 1.50"$) P = PIPE SOCKET WELD ($L_0 = 1.595"$) W = TUBE SOCKET WELD ($L_0 = 1.595"$) TS = ORBITAL TUBE WELD ($L_0 = 1.13"$) TS-3 = ORBITAL TUBE WELD ($L_0 = 3.00"$) TS-5 = ORBITAL TUBE WELD ($L_0 = 5.13"$)
INLET PORT SIZE 6 = 3/8 8 = 1/2														INLET CONNECTION F = FEMALE NPT ($L_1 = 1.595"$) M = MALE NPT ($L_1 = 1.50"$) MFS = MALE FACE SEAL ($L_1 = 1.50"$) P = PIPE SOCKET WELD ($L_1 = 1.595"$) W = TUBE SOCKET WELD ($L_1 = 1.595"$) TS = ORBITAL TUBE WELD ($L_1 = 1.13"$) TS-3 = ORBITAL TUBE WELD ($L_1 = 3.00"$) TS-5 = ORBITAL TUBE WELD ($L_1 = 5.13"$)
OUTLET PORT SIZE 6 = 3/8 8 = 1/2														
MATERIAL SS = STAINLESS STEEL 316L														

ELGILOY® REGISTERED TRADEMARK OF ELGILOY SPECIALTY METALS.

REPAIR KIT PN'S: RK-ST8SS-K, RK-ST8SS-PI

CUSTOM CONFIGURATIONS ARE AVAILABLE ON REQUEST. ALSO AVAILABLE MANUALLY OPERATED, SEE ST-8 SERIES.

Minimum order quantities may be required. Some inlet/outlet combinations may not be available.

VALVE, FITTING OR OTHER COMPONENT FUNCTION, PROPER INSTALLATION, MATERIALS COMPATIBILITY, ADEQUATE RATINGS, OPERATION AND MAINTENANCE ARE THE RESPONSIBILITY OF THE SYSTEM DESIGNER AND USER.



PRODUCT FAILURE, IMPROPER SELECTION OR IMPROPER USE OF THE PRODUCTS AND/OR SYSTEMS DESCRIBED HEREIN OR RELATED ITEMS CAN CAUSE DEATH, PERSONAL INJURY AND PROPERTY DAMAGE.



MADE IN USA

19 Industrial Road, Fairfield, NJ 07004 Phone: 973-276-9011 Fax: 973-276-9014 www.gasflo.com

