

ITEM	PART NAME	MATERIAL	QTY
1	NUT	303 SST	1
2	NIPPLE	316L SST	1

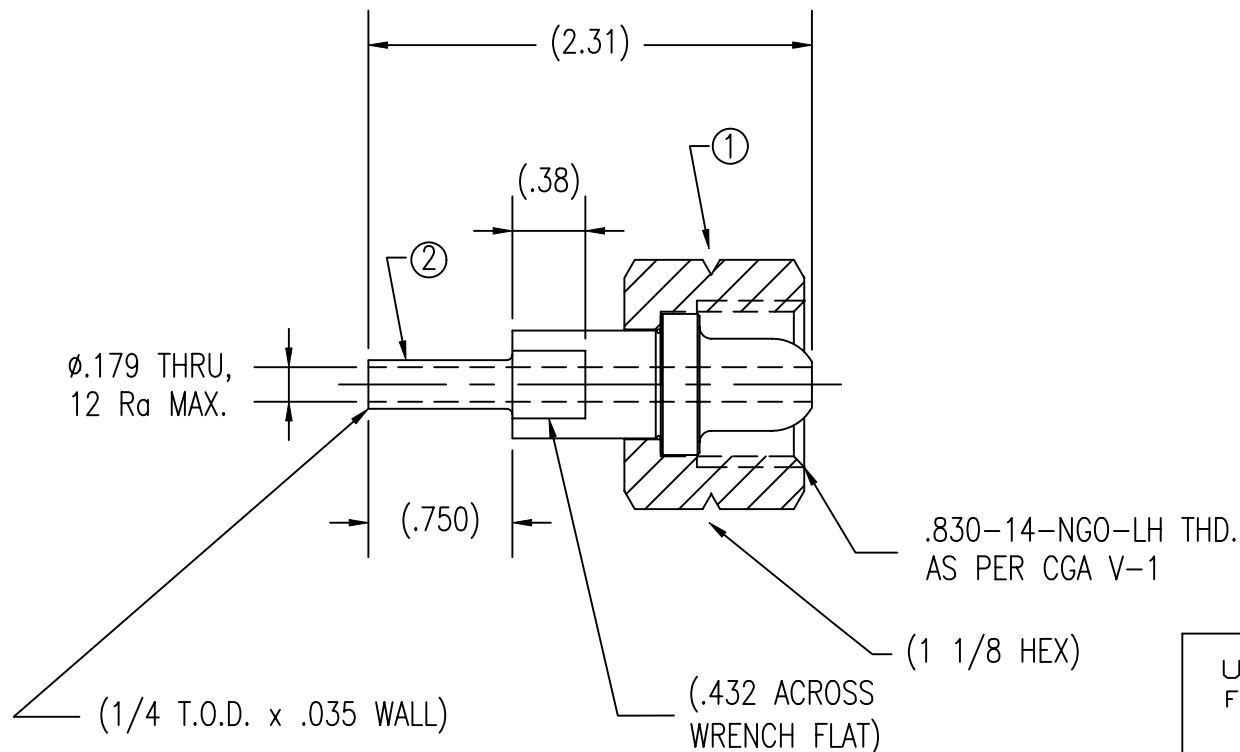

UNCONTROLLED  
For Reference Only

MB 8/1/2011

#### NOTES:

1. DIMENSIONS ARE IN INCHES.
2. ORDER PART NUMBER: INL-350SS-4TS-37F.
3. NIPPLE IS ULTRASONICALLY D.I. CLEANED AND SINGLE POLY BAGGED.
4. NUT IS CLEANED FOR OXYGEN SERVICE AND SINGLE POLY BAGGED.
5. ASSEMBLY IS BULK POLY BAGGED AND LABELED WITH GFP LOGO AND GFP PART NUMBER.

*GasFlo Products Inc.*  
*Fairfield, N.J.*

SALES DRAWING- INLET CONNECTION  
CGA 350 x 1/4" TUBE STUB

THIS DOCUMENT CONTAINS INFORMATION THAT IS THE PROPRIETARY AND CONFIDENTIAL PROPERTY OF GASFLO PRODUCTS INC. AND MAY BE USED ONLY FOR AUTHORIZED PURPOSES.  
THIS DOCUMENT MAY NOT BE REPRODUCED WITHOUT GASFLO PRODUCTS INC. PRIOR WRITTEN CONSENT.

DWN: MB

SCALE: NTS

APPVD:

DATE: 8/1/11

DWG: SALES-INL-350SS-4TS-37F