

ITEM	PART NAME	MATERIAL	QTY
1	NUT	1 1/4" HEX 303 SST	1
2	NIPPLE	7/8" HEX 316L SST	1

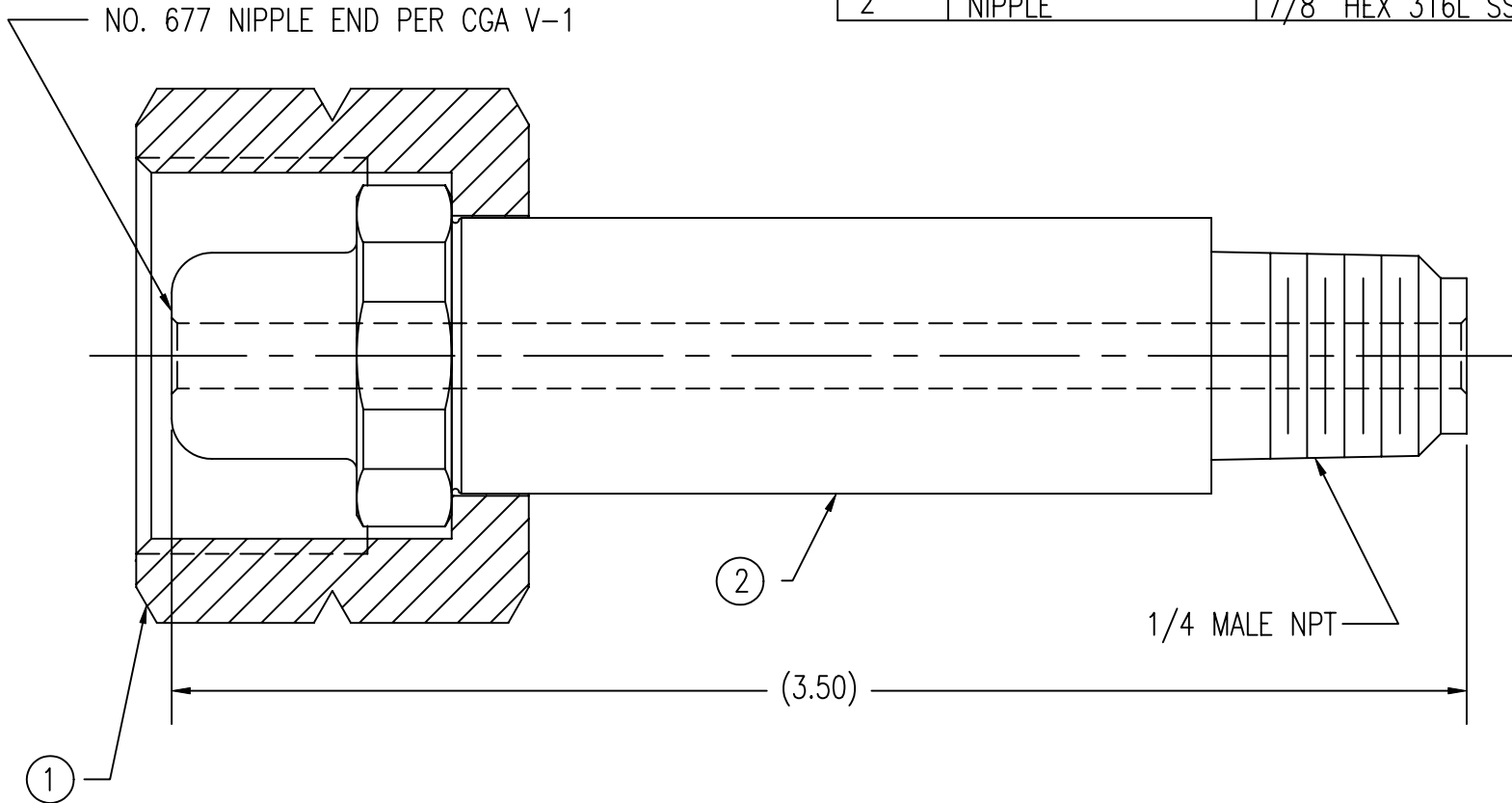

NOTES:

1. MAWP: 7500 PSIG
2. NIPPLE IS CLEANED FOR OXYGEN SERVICE AND SINGLE POLY BAGGED.
3. NUT IS CLEANED FOR OXYGEN SERVICE AND SINGLE POLY BAGGED.
4. ASSEMBLY IS SINGLE POLY BAGGED AND LABELLED WITH GFP LOGO AND PART NUMBER.

UNCONTROLLED
For Reference Only

MB 1/25/2012

GasFlo Products Inc.
Fairfield, N.J.

INLET; CGA 677 x 1/4" MNPT
3.50" OAL; 316L SST