

ITEM	PART NAME	MATERIAL	QTY.
1	NIPPLE	316L SST	1
2	NUT	303 SST	1
3	GASKET	PTFE	1

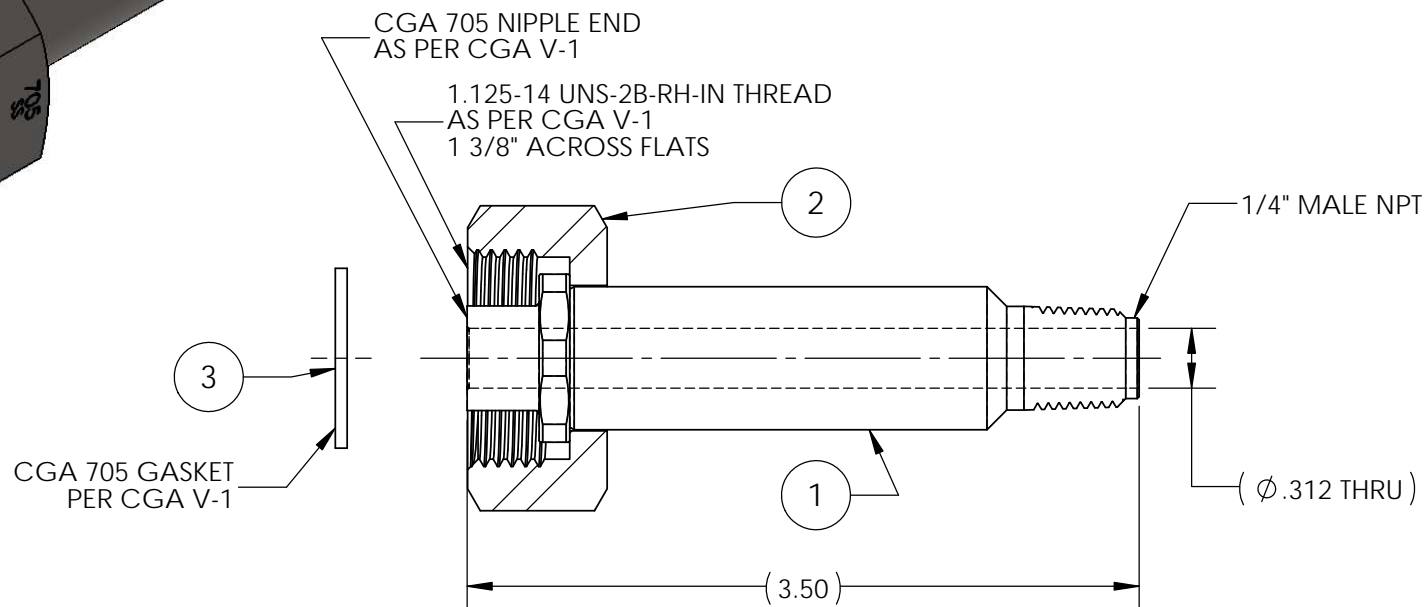
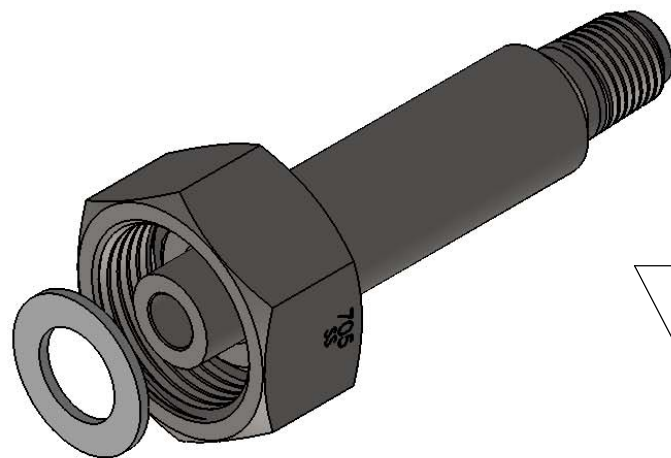

# NOTES:

1. DIMENSIONS ARE IN INCHES.
2. ORDER PART NUMBER: INL-705SS-4M-56.
3. NIPPLE, NUT, AND GASKET ARE CLEANED FOR OXYGEN SERVICE AND SINGLE POLY BAGGED.
4. ASSEMBLY IS BULK POLY BAGGED AND LABELED WITH GFP LOGO AND GFP PART NUMBER.

**SALES DRAWING**  
**UNCONTROLLED**  
**FOR**  
**REFERENCE**  
**ONLY**

REV	CURRENT REVISION	DATE
A	ESTABLISH GFP DRAWING FOR THIS ITEM	12/01/2016

DESCRIPTION:		
INLET CGA 705 X 1/4 MNPT 3.50 SS		
PART NUMBER:		
INL-705SS-4M-56		
SIZE: A	SCALE: NTS	MAT'L: SEE B.O.M.
SHEET NUMBER: 1 OF 1		DRAWN BY: BMugavero on 12/01/2016

**GFP**  
**GASFLO PRODUCTS**  
**Fairfield, NJ 07004**

THIS DOCUMENT CONTAINS INFORMATION THAT IS THE PROPRIETARY AND CONFIDENTIAL PROPERTY OF GASFLO PRODUCTS INC. AND MAY BE USED ONLY FOR AUTHORIZED PURPOSES. THIS DOCUMENT MAY NOT BE REPRODUCED WITHOUT GASFLO PRODUCTS INC. PRIOR WRITTEN CONSENT.

APPR: mbojcik on 12/02/2016