

UNCONTROLLED
For Reference Only
MB 3/30/2007

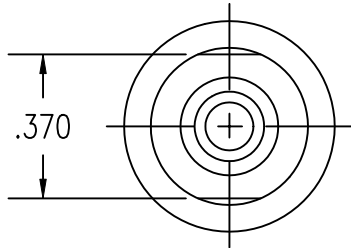

1/4" TUBE STUB END

CGA 180 END AS PER
CGA V-1

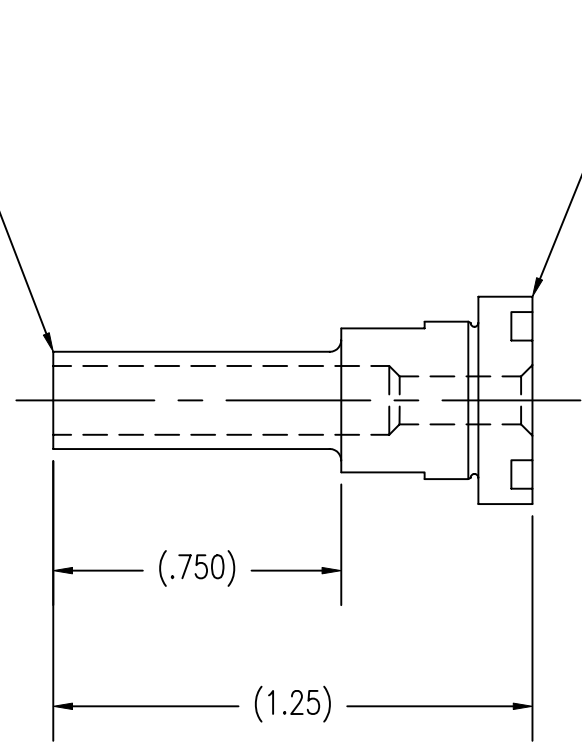

NOTES:

1. DIMENSIONS ARE IN INCHES.
2. ITEM IS ULTRASONICALLY D.I. CLEANED & SINGLE POLY BAGGED.

GasFlo Products Inc.
Fairfield, N.J.

SALES DRAWING- NIPPLE
CGA 180 x 1/4 TUBE END

THIS DOCUMENT CONTAINS INFORMATION THAT IS THE PROPRIETARY AND CONFIDENTIAL PROPERTY OF GASFLO PRODUCTS INC. AND MAY BE USED ONLY FOR AUTHORIZED PURPOSES. THIS DOCUMENT MAY NOT BE REPRODUCED WITHOUT GASFLO PRODUCTS INC. PRIOR WRITTEN CONSENT

MAT'L	316L SST
DWN MB	SCALE: NTS
APPVD	DATE 9/2/05

DWG SALES-NIP-180SS-4TS-20F