

(MARK AS SHOWN:
2MM HIGH "170"; 1 1/2MM HIGH "SS"
MARKING MUST BE PERMANENT)

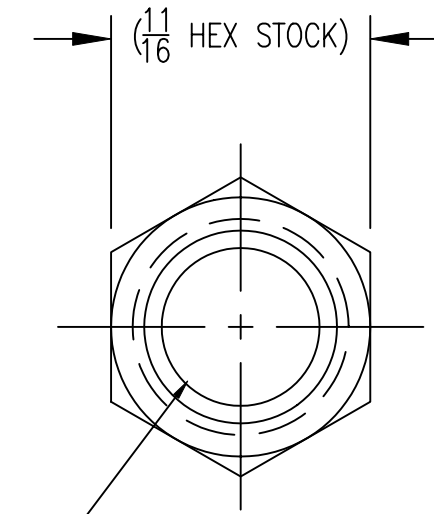

$(\phi.411-.416 \text{ THRU})$
THREAD AS PER CGA V-1

UNCONTROLLED
For Reference Only

MB 3/30/2007

NOTES:

1. DIMENSIONS ARE IN INCHES.

GasFlo Products Inc.
Fairfield, N.J.

SALES DWG.- CGA 170 NUT

MAT'L: 303 SST

THIS DOCUMENT CONTAINS INFORMATION THAT IS THE PROPRIETARY AND CONFIDENTIAL PROPERTY OF GASFLO PRODUCTS INC. AND MAY BE USED ONLY FOR AUTHORIZED PURPOSES. THIS DOCUMENT MAY NOT BE REPRODUCED WITHOUT GASFLO PRODUCTS INC. PRIOR WRITTEN CONSENT.

DWN: MB

SCALE: NTS

SHEET: 1 of 1

DATE: 12/2/97

DWG: NUT-170SS