

ITEM	PART NAME	MATERIAL	QTY.
1	NIPPLE	CDA-360 BRASS	1
2	NUT	CDA-360 BRASS	1

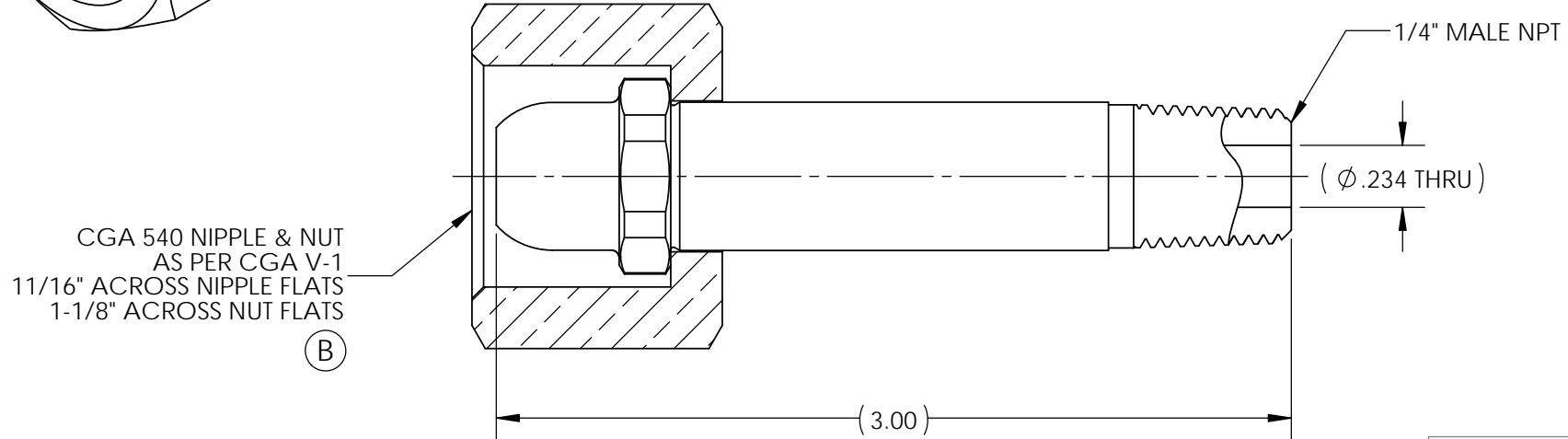

NOTES:

1. DIMENSIONS ARE IN INCHES.
2. ALL COMPONENTS ARE SINGLE POLY BAGGED. ASSEMBLY IS BULK POLY BAGGED AND LABELED WITH GFP LOGO, PART NUMBER, "CLEANED FOR OXYGEN SERVICE", AND "MADE IN THE USA".

SALES DRAWING
UNCONTROLLED
FOR
REFERENCE
ONLY

REV	CURRENT REVISION	DATE
A	REDRAWN PER CURRENT GASFLO SALES DRAWING STANDARD; ADDED ISOMETRIC VIEW	04/13/2018

DESCRIPTION:		
INLET CGA 540 X 1/4 MNPT 3.00 BR		
PART NUMBER:		
INL-540BR-4M-48		
SIZE: A	SCALE: NTS	MAT'L: SEE B.O.M.
SHEET NUMBER: 1 OF 1		DRAWN BY: BMugavero on 04/25/2016

GFP
GASFLO PRODUCTS
Fairfield, NJ 07004

THIS DOCUMENT CONTAINS INFORMATION THAT IS THE PROPRIETARY AND CONFIDENTIAL PROPERTY OF GASFLO PRODUCTS INC. AND MAY BE USED ONLY FOR AUTHORIZED PURPOSES. THIS DOCUMENT MAY NOT BE REPRODUCED WITHOUT GASFLO PRODUCTS INC. PRIOR WRITTEN CONSENT.

APPR: mbojcik on 04/23/2019