

ITEM	PART NAME	MATERIAL	QTY.
1	NIPPLE	316L SCM SST	1
2	NUT	303 SST	1

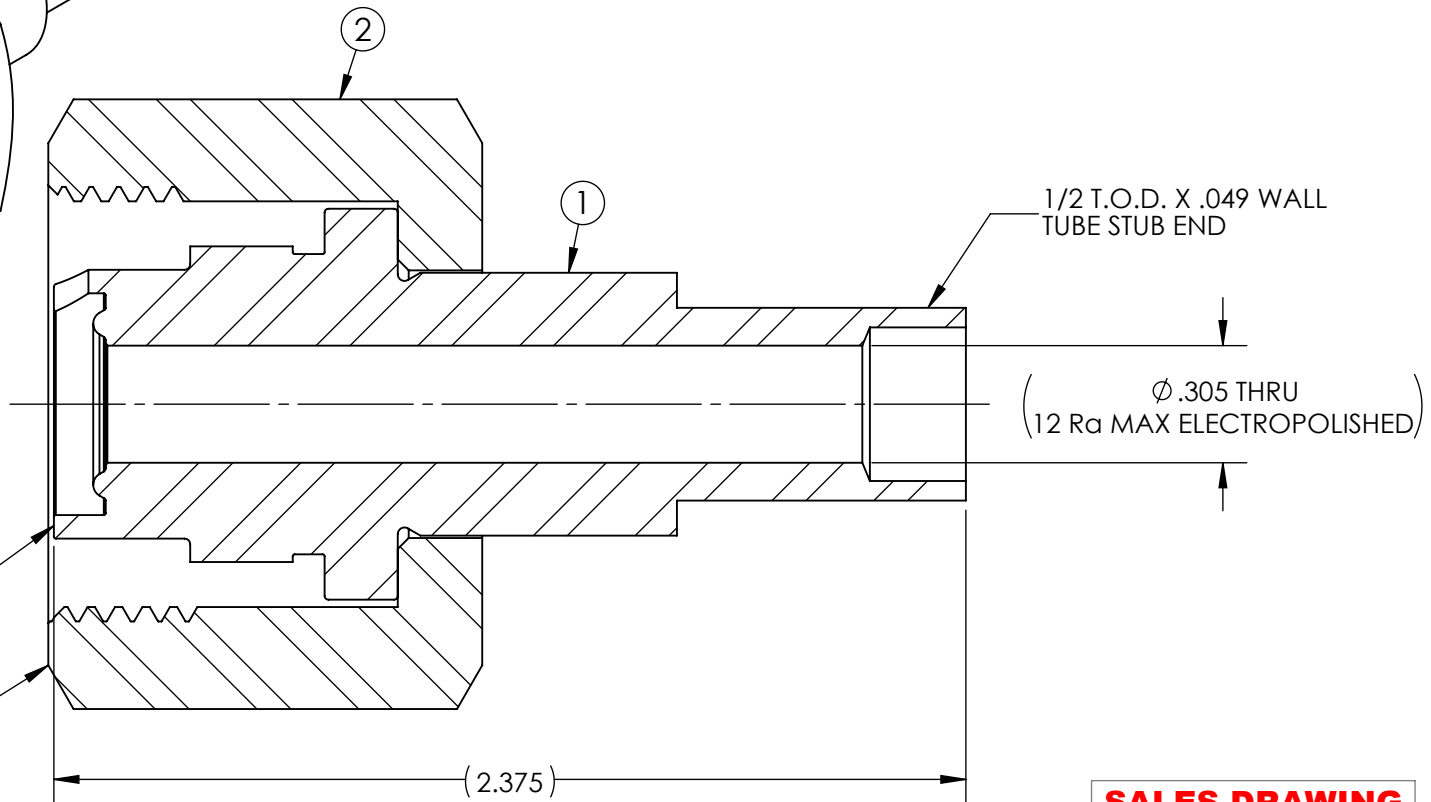
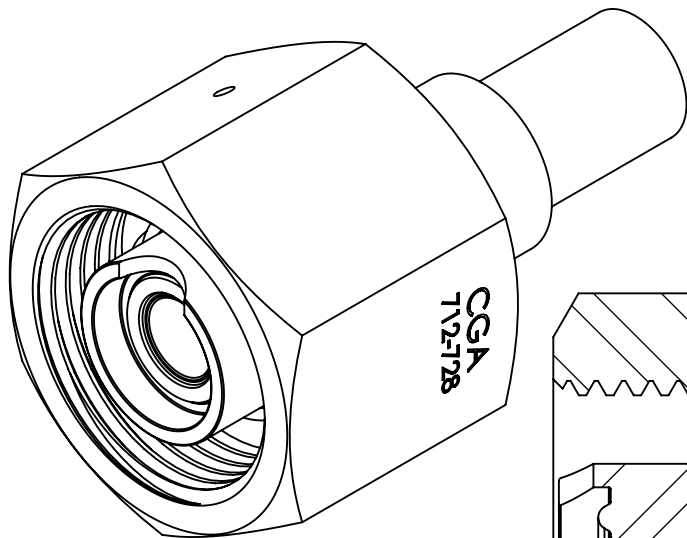

CGA 720 NIPPLE END
AS PER CGA V-1

1.130-14 NGO RH
SILVER PLATED THREAD
AS PER CGA V-1
1-3/8" ACROSS FLATS

1/2 T.O.D. X .049 WALL
TUBE STUB END

Ø .305 THRU
(12 Ra MAX ELECTROPOLISHED)

(2.375)

SALES DRAWING
UNCONTROLLED
FOR
REFERENCE
ONLY

NOTES:

1. MAWP: 3000 PSI.
2. NIPPLE IS D.I. ULTRACLEANED AND DOUBLE BAGGED.
3. NUT IS CLEANED FOR OXYGEN SERVICE AND SINGLE BAGGED.
4. ASSEMBLY IS SINGLE POLY BAGGED. BAG IS LABELED WITH GFP LOGO, PART NUMBER, "D.I. ULTRACLEANED", AND "MADE IN THE USA".

REV	CURRENT REVISION	DATE
A	ESTABLISH GFP SALES DRAWING FOR THIS ITEM	01/06/2022

DESCRIPTION: INLET CGA 720 X 1/2 TS SS		
PART NUMBER: INL-720SS-8TS		
SIZE: A	SCALE: NTS	MAT'L: SEE B.O.M.
SHEET NUMBER: 1 OF 1		DRAWN BY: aparadiseasher on 01/14/2016



THIS DOCUMENT CONTAINS INFORMATION THAT IS THE PROPRIETARY AND CONFIDENTIAL PROPERTY OF GASFLO PRODUCTS INC. AND MAY BE USED ONLY FOR AUTHORIZED PURPOSES. THIS DOCUMENT MAY NOT BE REPRODUCED WITHOUT GASFLO PRODUCTS INC. PRIOR WRITTEN CONSENT.

APPR: mbojcik on 01/06/2022