

ITEM	PART NAME	MATERIAL	QTY.
1	NIPPLE	316L SST	1
2	GASKET	TEFLON	1
3	NUT	303 SST	1

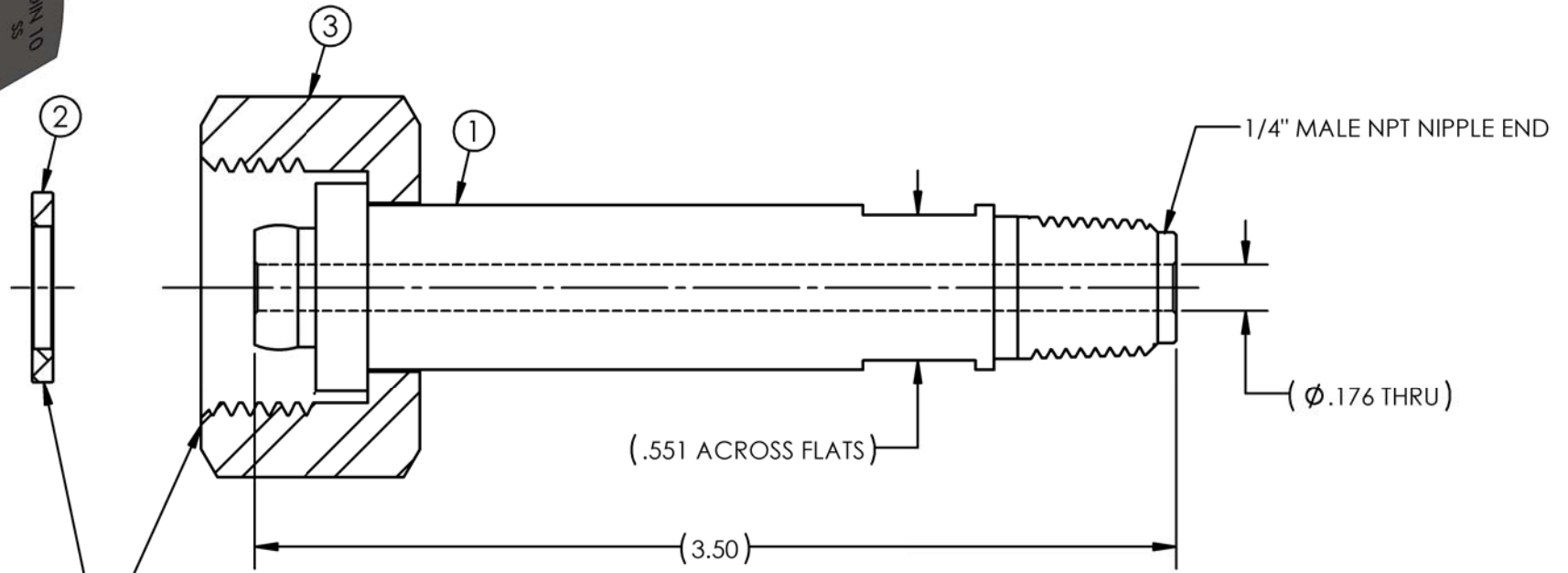
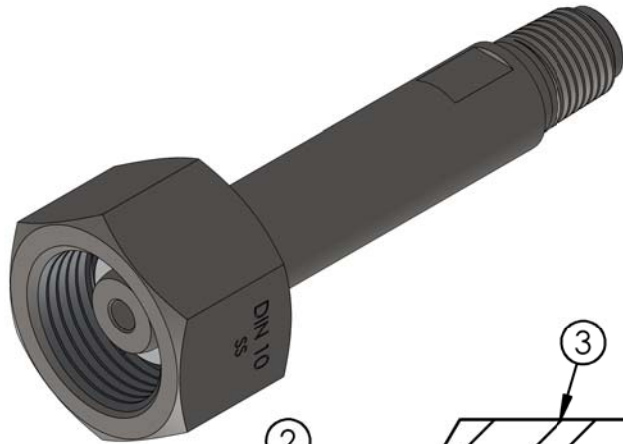

DIN 10 NIPPLE, NUT, & GASKET
AS PER DIN 477-1
(WITH SILVER PLATED THREADS)
1-1/4" ACROSS FLATS

SALES DRAWING
UNCONTROLLED
FOR
REFERENCE
ONLY

NOTES:

1. DIMENSIONS ARE IN INCHES.
2. NIPPLE AND NUT ARE CLEANED FOR OXYGEN SERVICE AND SINGLE POLY BAGGED.
3. ALL COMPONENTS ARE SINGLE POLY BAGGED. ASSEMBLY IS BULK POLY BAGGED AND LABELED WITH GFP LOGO, PART NUMBER, "CLEANED FOR OXYGEN SERVICE", AND "MADE IN THE USA".

REV	CURRENT REVISION	DATE
A	ESTABLISH GFP DRAWING FOR THIS ITEM	03/22/2016

DESCRIPTION: INLET DIN 10 X 1/4 MNPT 3.50 SS		
PART NUMBER: INL-D10SS-4M-56		
SIZE: A	SCALE: NTS	MAT'L: SEE B.O.M.
SHEET NUMBER: 1 OF 1		DRAWN BY: BMugavero on 03/22/2016



THIS DOCUMENT CONTAINS INFORMATION THAT IS THE PROPRIETARY AND CONFIDENTIAL PROPERTY OF GASFLO PRODUCTS INC. AND MAY BE USED ONLY FOR AUTHORIZED PURPOSES. THIS DOCUMENT MAY NOT BE REPRODUCED WITHOUT GASFLO PRODUCTS INC. PRIOR WRITTEN CONSENT.

APPR: mbojck on 02/07/2019