

SPECIFICATIONS:

PRESSURE RATING: 3000 PSIG  
 FLOW COEFFICIENT: Cv=.26  
 SEAT ORIFICE SIZE:  $\phi$ .125  
 TEMP. LIMITS: -65 TO 150°F  
 MAX. ALLOW. LEAK:  $2 \times 10^{-8}$  ATM CC/SEC  
 WETTED SURFACES: 316L SST, PCTFE

| ITEM | PART NAME       | MATERIAL        | QTY |
|------|-----------------|-----------------|-----|
| 1    | BODY            | 316L SST        | 1   |
| 2    | SEAT INSERT     | PCTFE (KEL-F)   | 1   |
| 3    | DIAPHRAGM ASSY. | 316L SST/COPPER | 1   |
| 4    | BONNET          | 303 SST         | 1   |
| 5    | UPPER STEM      | 416 SST         | 1   |
| 6    | HANDLE          | ABS PLASTIC     | 1   |
| 7    | WASHER          | 18-8 SST        | 1   |
| 8    | SCREW           | 18-8 SST        | 1   |
| 9    | LOWER STEM      | 316L SST        | 1   |
| 10   | SPRING          | 316L SST        | 1   |
| 11   | LABEL           | VINYL/MYLAR     | 1   |

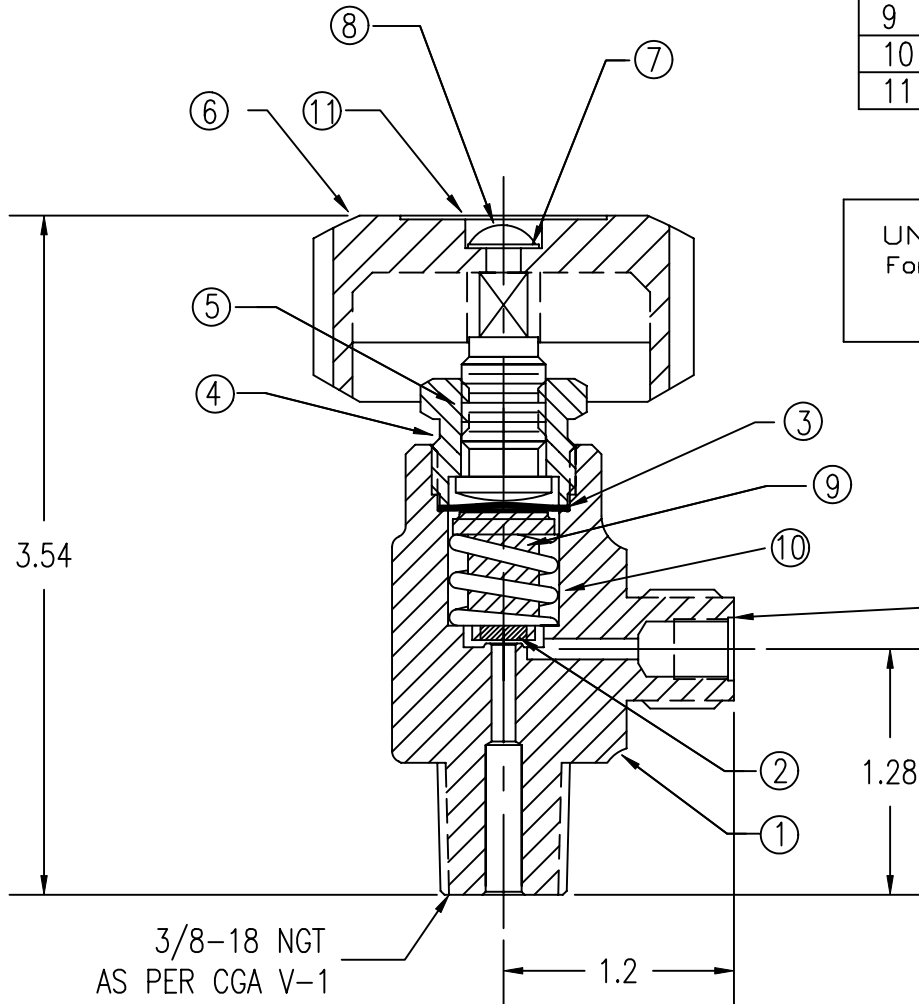

UNCONTROLLED  
 For Reference Only  
 MB 3/30/2007

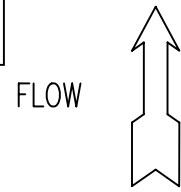

NUMBER 180/110 VALVE OUTLET AS PER CGA V-1.

*GasFlo Products Inc.*  
*Fairfield, N.J.*

SALES DRAWING- LECTURE BOTTLE VALVE  
 3/8-18NGT x 180/110 OUTLET

THIS DOCUMENT CONTAINS INFORMATION THAT IS THE PROPRIETARY AND CONFIDENTIAL PROPERTY OF GASFLO PRODUCTS INC. AND MAY BE USED ONLY FOR AUTHORIZED PURPOSES. THIS DOCUMENT MAY NOT BE REPRODUCED WITHOUT GASFLO PRODUCTS INC. PRIOR WRITTEN CONSENT.

DWN MB SCALE: 1:1  
 APPVD DATE 7/9/01

DWG SALES-VLV-LB-6180SS-MM