

ITEM	PART NAME	MATERIAL	QTY
1	BODY	316L SST	1
2	SEAT INSERT	PCTFE	1
3	DIAPHRAGM ASSY.	316L SST/COPPER	1
4	BONNET	303 SST	1
5	STEM	416 SST	1
6	HANDLE	BLACK ABS PLASTIC	1
7	WASHER	18-8 SST	1
8	SCREW	18-8 SST	1
9	LABEL	VINYL/MYLAR	1

SPECIFICATIONS:

PRESSURE RATING: 3500 PSI

FLOW COEFFICIENT $C_v = .13$

SEAT ORIFICE SIZE: .125 ϕ

SEAT MATERIAL: PCTFE

TEMPERATURE LIMITS:

-65° F TO 150° F

MAX. ALLOWABLE SEAT LEAKAGE:

2 x 10⁻⁸ ATM CC/SEC He

MAX. INBOARD LEAKAGE:

2 x 10⁻⁸ ATM CC/SEC He

WETTED SURFACES: 316L SST,
PCTFE.

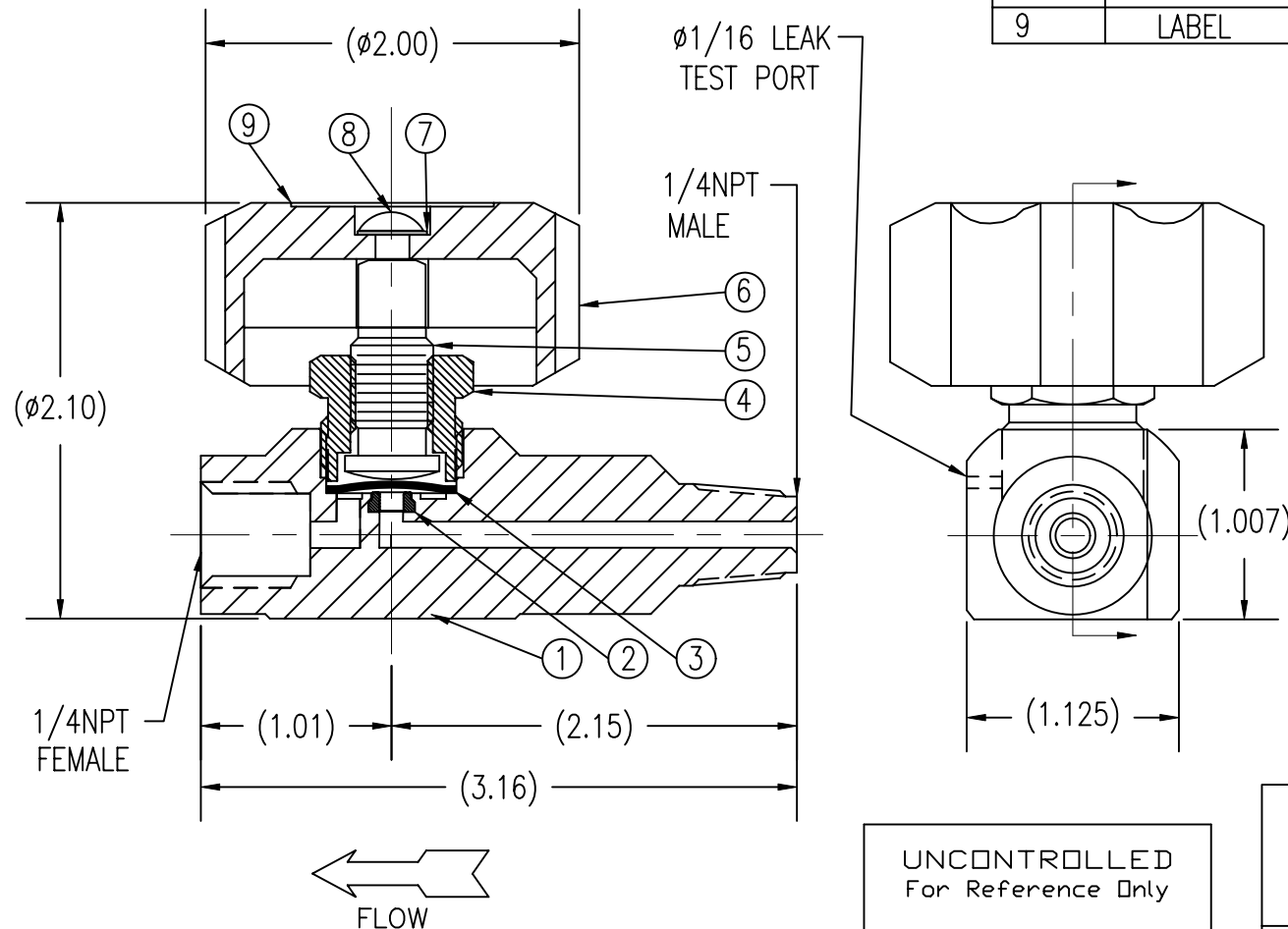

UNCONTROLLED
For Reference Only

MB 3/30/2007

NOTES:

1. DIMENSIONS ARE IN INCHES.

THIS DOCUMENT CONTAINS INFORMATION THAT IS THE PROPRIETARY AND CONFIDENTIAL PROPERTY OF GASFLO PRODUCTS INC. AND MAY BE USED ONLY FOR AUTHORIZED PURPOSES.
THIS DOCUMENT MAY NOT BE REPRODUCED WITHOUT GASFLO PRODUCTS INC. PRIOR WRITTEN CONSENT.

DWN MB
APPVD

SCALE: 1:1

DATE 6/27/01

GasFlo Products Inc.
Fairfield, N.J.

SALES DRAWING—
LONG LEG PACKLESS BARSTOCK VALVE

DWG SALES-VLV-LL-44SS-MF